

OMRON

MODEL E2E-X7T1-Z-HW

- 接近传感器
- PROXIMITY SENSOR

使用说明书 INSTRUCTION SHEET

非常感谢您使用欧姆龙产品。为了安全使用本产品，请在使用前阅读本说明书，充分理解其中内容。阅读完毕后，进行使用时请将本书置于身边。

Thank you for selecting OMRON sensors. Please carefully read the following instructions and precautions before installing and using the sensor. Please keep this instruction sheet for future reference.

TRACEABILITY INFORMATION:
Representative in EU: Omron Europe B.V. Wegalaan 67-69, 2132 JD Hoofddorp, The Netherlands
Manufacturer: Omron Corporation, Shiokoji Horikawa, Shimogyo-ku, Kyoto 600-8530 JAPAN
Shanghai Factory No.789 Jinji Road, Jinqiao Export Processing District, Pudong New Area, Shanghai, 201206 CHINA

The following notice applies only to products that carry the CE mark:
Notice:
This is a class A product. In residential areas it may cause radio interference, in which case the user may be required to take adequate measures to reduce interference.

PROXIMITY SENSOR

QTY.

1

欧姆龙株式会社

© OMRON Corporation 2013 All Rights Reserved.

2287489-0A

安全上的注意

- 警告表示的意思



如果不正确使用的话，有可能引起轻伤、中等程度的伤害，还有可能带来同样重大的物质损害。

使用前的注意事项

在下列条件、环境使用时，除了考虑规格、功能裕量或是失效安全性等因素外，请务必与本公司销售人员联系：

- (1) 在使用说明书中没有记载的条件、环境中使用；
- (2) 用于原子能控制、铁道、航空、车辆、燃烧装置、医疗器件、娱乐器件、安全器材等；
- (3) 预计对生命财产有较大影响、特别是对安全性有特别要求的场合；

PRECAUTIONS IN USING THE PRODUCT

When the product is used under the circumstances or environment below, ensure adherence to limitations of the ratings and functions. Also, take countermeasure for safety precautions such as fail-safe installations.

- (1) Use under the circumstances or environment which are not described in the instruction manual.
- (2) Use for nuclear power control, railroad, aircraft, vehicles, incinerator, medical equipment, entertainment equipment, safety device etc...
- (3) Use for the applications where death or serious property damage is possible and extensive safety precautions are required.

PRECAUTIONS ON SAFETY

- Meaning of Signal Words



Indicates a potentially hazardous situation which, if not avoided, may result in minor or moderate injury or in property damage.

安全上的要点

- (1) 请不要超过额定电压范围使用。施加额定电压以上的电压，或给直流电源型的传感器接上交流电源(AC220V)，可能导致产品烧毁，破裂。
- (2) 请不要将负载短路，没有负载不要直接接电源，可能导致产品破裂或烧毁。
- (3) 请不要颠倒电源的极性接线。可能导致产品破裂，烧毁。
- (4) 当在金属板上安装传感器时，请确保空隙值大于表1给定值，否则会影响传感器性能。
- (5) 不要用过大的力紧固螺母，按表2中对应的力矩紧固螺母。
- (6) 当两个或多个接近传感器安装的很近时，确保表3对应型号的最小空间距离，不同频率的机种为括号里的值。
- (7) 当接近传感器安装在孔里时，安装尺寸如表4所示。

Please note that the proximity sensor may be damaged if used as follows:

- (1) If the applied voltage exceeds the rated specification.
- (2) If there is a short circuit of the output load or if directly connected to the power supply without a load.
- (3) If the polarity of the power supply is reversed or other incorrect wiring.
- (4) When mounting the proximity sensor in a metal panel, maintain the clearances given in table 1. If the clearances are not observed, a deterioration in sensor performance may occur.
- (5) Do not tighten the sensor mounting nuts with excessive force. Secure the mounting nuts to the corresponding torque values for part A and part B in table 2.
- (6) When installing two or more proximity sensors close together, ensure the minimum separation distances given in table 3. The values in parentheses the minimum separation distances when using different frequency type.
- (7) When mounting the proximity sensor in a mounting hole, maintain the dimensions given in table 4.

正确使用方法

■ 周围金属的影响

接近传感器嵌入金属的情况时，请在下表所示数值以上使用。

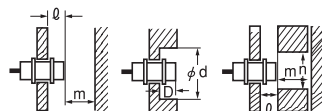

Table 1 (mm)

直径 (Diameter)	M18
屏蔽有无 (shielded)	屏蔽 (shielded)
Model	E2E-X7T1-Z-HW
Item	
l	0
d	18
D	0
m	20
n	27

■ 安装

不要用过大的力紧固螺母。紧固时务必使用齿扣垫圈。



屏蔽型



注1 图的A和B处使用垫圈时，紧固允许强度如下表所示。

Table 2

形式 (Model)	A	B
	强度 (Torque)	
M18	70N·m	

■ 安装孔加工尺寸和螺母对角尺寸

(Mounting hole and nut dimensions)

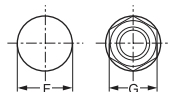

Table 4

接近传感器直径 (Diameter of Proximity Sensor)	F (mm)	G (mm)
M18	$\phi 18.5^{+0.5}_0$	24

■ 相互干涉

2个以上的接近传感器相对或并列配置时，请在下表所示值以上使用。

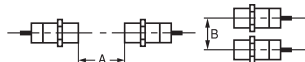

Table 3 (mm)

项目 (Item)	形式 (Model)	E2E-X7T1-Z-HW
	A	
B		35

■ 输出回路图

OUTPUT CIRCUIT

E2E-X7T1-Z-HW

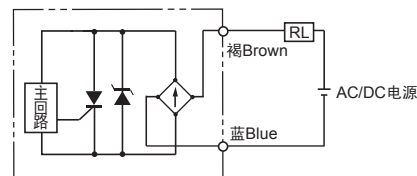

■ 外形尺寸

Dimensions

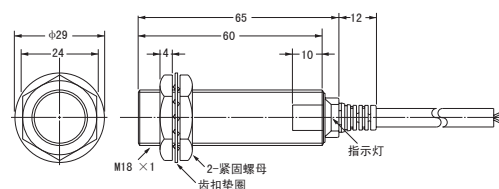

■ 技术咨询

欧姆龙 (中国) 有限公司
地址：中国上海市浦东新区银城中路200号
中银大厦2211室
电话：(86) 21-5037-2222
技术咨询热线：400-820-4535
网址：<http://www.fa.omron.com.cn>